

DGC8446F

8MP 4-in-1 Motorized IR Dome Camera



● FEATURES

- (1) 1/2.8" SONY CMOS Sensor with 8MP video output
- (2) Quadbrid video output with TVI, CVI, AHD & CVBS to fulfill different customers' requirements
- (3) Starlight visibility (0.001 Lux / F1.4) to offer clear & color images even at night
- (4) WDR to increase image recognizability in overexposure and dark areas
- (5) Day and night 24-hour surveillance with IR effective distance to 25 meters
- (6) IP66 for weather-proof application
- (7) Camera parameters adjustable when used with AVTECH HD CCTV DVR

● DIMENSIONS*

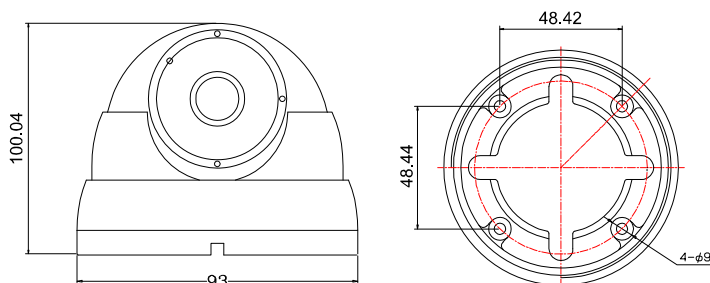

*Dimensional Tolerance: ± 5mm

● SPECIFICATIONS*

MODEL	DGC8446F
Video Mode	TVI, CVI, AHD & CVBS switchable
Pick-up Element	1/2.8" SONY CMOS
Number of Pixels	3840(H)×2160(V)
Video Frame Rate	TVI /CVI / AHD: 15fps@3840x2160P CVBS: 25/30fps@960H
Min. Illumination	0.001Lux / F1.4 (AGC ON), 0 Lux (IR LED ON)
S/N Ratio	62dB
Shutter Speed	AUTO / Manual (1/25-1/50,000s)
Lens	f2.8 ~ 12mm / F1.4
Lens Angle	Wide: 108.1° (Horizontal) / 56.3° (Vertical) / 130.9° (Diagonal) Tele: 30.3° (Horizontal) / 17.1° (Vertical) / 34.8°(Diagonal)
IR LED	18 units
IR Effective Distance	25 meters
Day & Night Mode	Auto / Color / (B/W) / EXT
Noise Reduction	2D / 3D-DNR
White Balance	ATW / Manual
AGC	YES
BLC	YES
WDR	YES
Flip	YES
Mirror	YES
IP Rating	IP66
Operating Temperature	-20°C ~ 60°C
Operating Humidity	10% - 90%RH
Power Source (±10%)	DC12V
Power Consumption (±10%)	< 8W
Net Weight (g)	502.5

* The specifications are subject to change without notice.