

SL-180 Electromagnetic Lock (small)

Without door position detection output

- Holding force : 150kg (300lbs)
- All materials used are fire proof
- Fail-safe (power to lock) electric lock suitable for **fire exit**
- 12vDC or 24v (adjustable)
- Current : 360mA 12v or 180mA 24v
- Operation temp. 0^o-90^o C
- Humidity : 85%Rh Max.
- Dimentions : Body : 165x36x21mm
- Armature : 140x33x11mm
- Weight : 1150g
- Certification ; CE

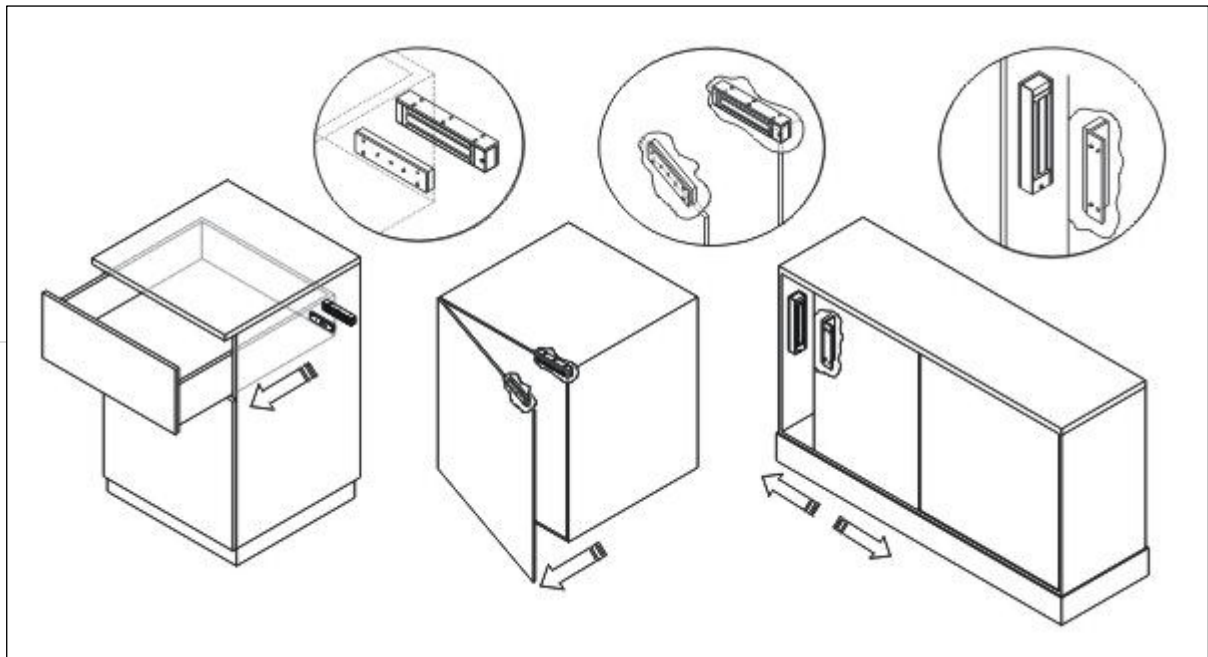

VandalVeto[®]