



	Floor Bracket / Soporte para cementar Plaque de fixation / Supporto per cementare	1
	Nut / Tuerca / Ecrou / Dado DIN 985 M8	3
	Washer / Arandela / Molette / Rondella DIN125 M8	3
	Bar / Varilla / Piquet / Tirante M8	3
	Nut / Tuerca / Ecrou / Dado DIN 934 M8	6





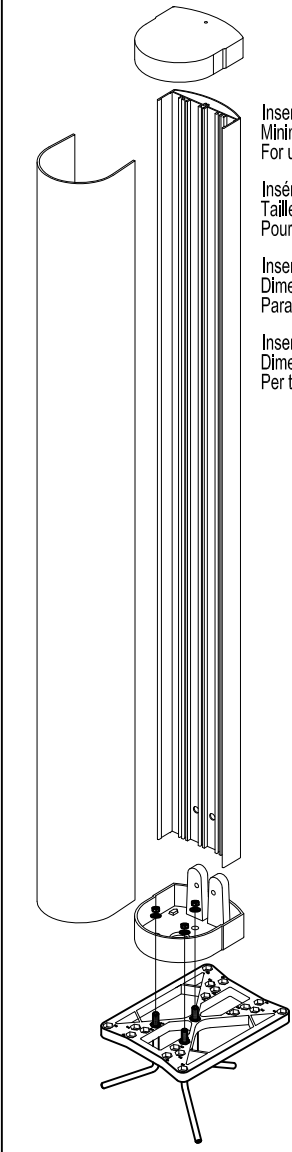
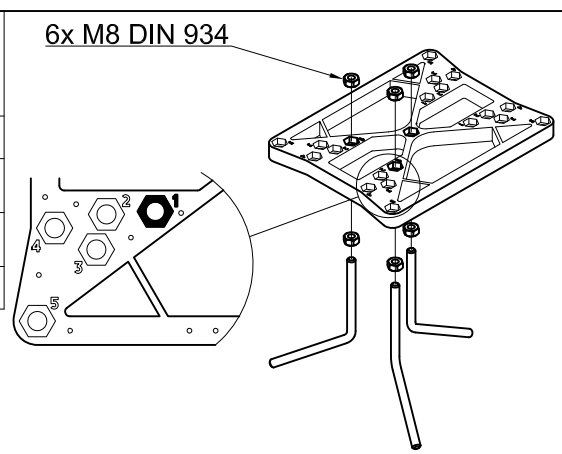

Insert cable access conduit(s) into the concrete while it is wet  
 Minimum base dimensions in firm soil: cube of 0.4m sides (towers up 2m high) and 0.5m sides (for 3m)  
 For unstable soil a more substantial base (or additional fixings- not supplied) is a must

Insérer le tuyau flexible dans le béton pendant qu'il est humide  
 Taille minimale de base in sol ferme: 0,4 m cube de côtés (tours jusqu'à 2m de haut) et 0,5 m côtés (pour 3m)  
 Pour un sol instable, une base plus importante (ou plus-fixations non fourni) peut être nécessaire

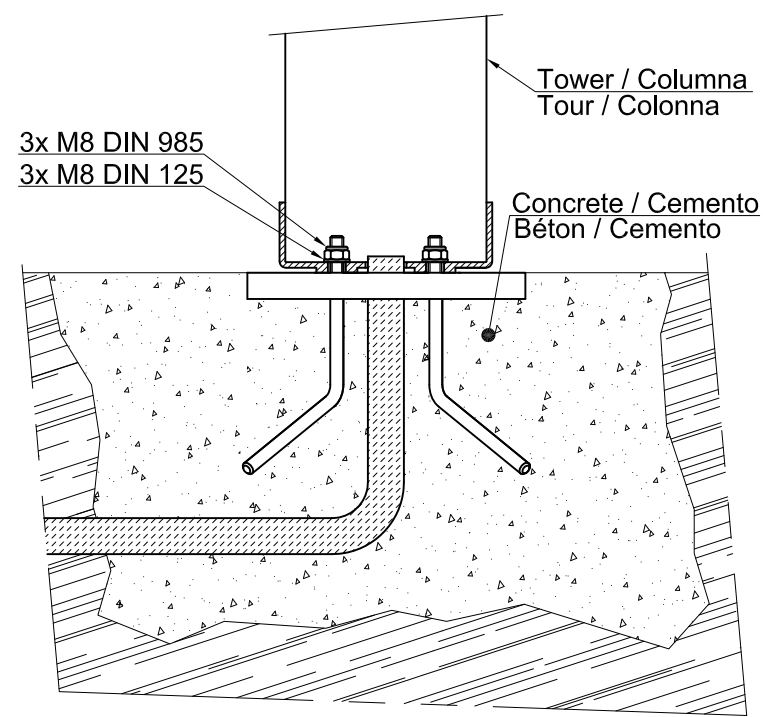
Insertar el cable corrugado en el cemento mientras esté humedo  
 Dimensiones minimas del cemento en suelo firme: cubo de 0,4m de lado (columnas hasta 2m) y 0,5m (columnas de 3m)  
 Para suelos no firmes es necesaria una base mayor (o el uso de otros componentes de fijación no suministrados)

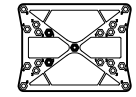
Inserire il cavo corrugato nel cemento mentre sia umido  
 Dimensioni minime gettata in suolo stabile: cubo di 0,4m di lato (colonne fino a 2m) e 0,5m di lato (per colonne 3m)  
 Per terreni non stabili è necessaria una gettata maggiore (o l'uso di altri componenti di fissaggio non forniti)



	Floor Bracket / Soporte para cementar Plaque de fixation / Supporto per cementare	1
	Nut / Tuerca / Ecrou / Dado DIN 985 M8	3
	Washer / Arandela / Molette / Rondella DIN125 M8	3
	Bar / Varilla / Piquet / Tirante M8	3
	Nut / Tuerca / Ecrou / Dado DIN 934 M8	6

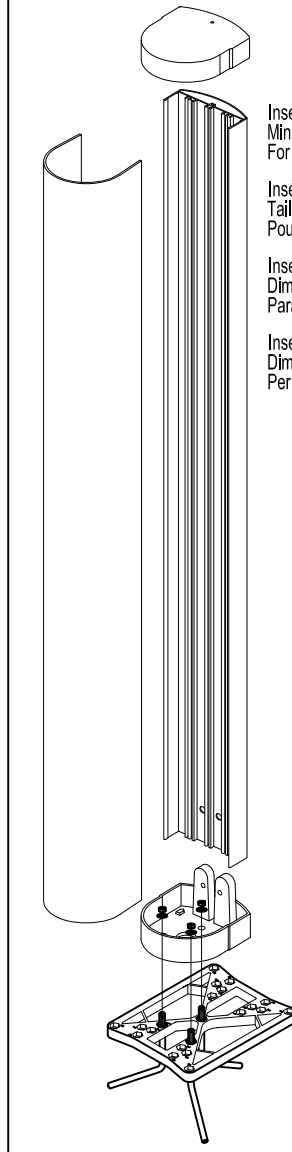
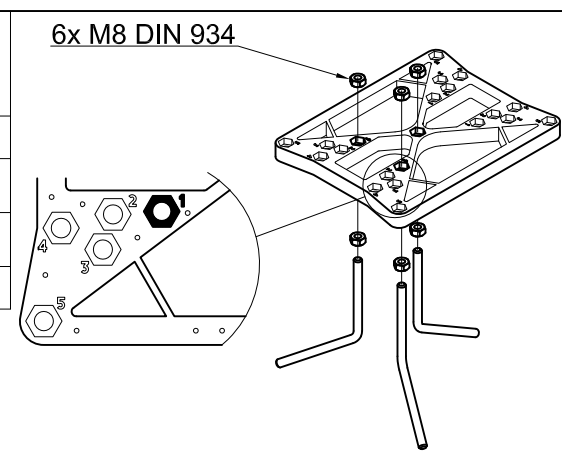

Insert cable access conduit(s) into the concrete while it is wet  
 Minimum base dimensions in firm soil: cube of 0.4m sides (towers up 2m high) and 0.5m sides (for 3m)  
 For unstable soil a more substantial base (or additional fixings- not supplied) is a must

Insérer le tuyau flexible dans le béton pendant qu'il est humide  
 Taille minimale de base in sol ferme: 0,4 m cube de côtés (tours jusqu'à 2m de haut) et 0,5 m côtés (pour 3m)  
 Pour un sol instable, une base plus importante (ou plus-fixations non fourni) peut être nécessaire

Insertar el cable corrugado en el cemento mientras esté humedo  
 Dimensiones minimas del cemento en suelo firme: cubo de 0,4m de lado (columnas hasta 2m) y 0,5m (columnas de 3m)  
 Para suelos no firmes es necesaria una base mayor (o el uso de otros componentes de fijación no suministrados)

Inserire il cavo corrugato nel cemento mentre sia umido  
 Dimensioni minime gettata in suolo stabile: cubo di 0,4m di lato (colonne fino a 2m) e 0,5m di lato (per colonne 3m)  
 Per terreni non stabili è necessaria una gettata maggiore (o l'uso di altri componenti di fissaggio non forniti)

