

VandalVeto® #200117 12V65Ah

Sealed Rechargeable Lead Acid Battery



SPECIFICATIONS	
Cells Per Unit	6
Voltage Per Unit	12
Capacity	65Ah@10hr-rate to 1.75V per cell@25°C
Weight	Approx. 20kg
Max. Discharge Current	650A (5sec)
Internal Resistance	Approx. 5.5mΩ
Operating Temperature Range	Discharge: -40°C~50°C
	Charge: -20°C~50°C
	Storage: -20°C~50°C
Normal Operating Temperature Range	25°C±5°C
Float charging Voltage	13.50 to 13.80V DC/unit Average at 25°C
Max. Charging Current	16.25A
Equalization and Cycle service	14.70 to 15.00V DC/unit Average at 25°C
Self Discharge	The batteries can be stored for more than 6 months at 25°C. Please charge batteries before using. For high temperature, the time interval will be shorter.
Terminal	T14
Container Material	ABS(UL94-HB) Flammability resistance of UL94-V0 is available on request.

APPLICATION

- Electric tools
- Vehicle in place of walking
- Lawn mowers
- Golf trolleys and golf cart
- Portable apparatus, lights and instruments;
- Electric toys
- Illumination light
- Fire alarms
- Portable power
- Wheelchairs
- Medical equipments.



ISO9001

DIMENSIONS

Unit: mm

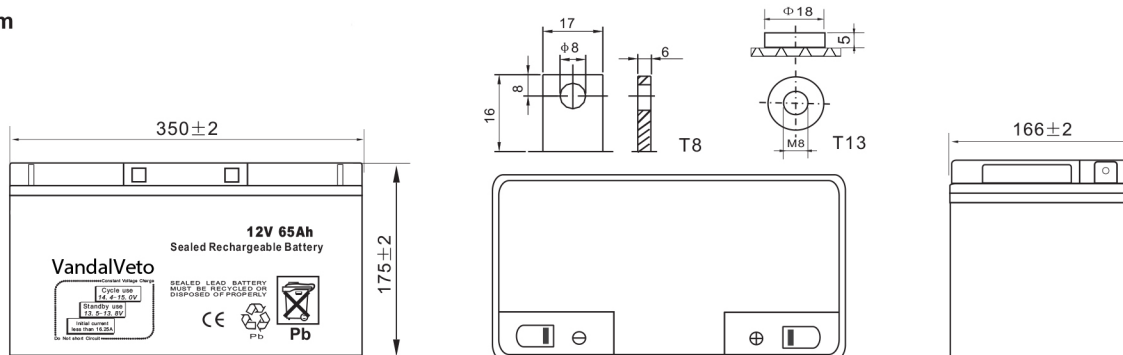

Constant Current Discharge Characteristics Unit:A(25°C,77°F)

F.V/Time	5min	10min	15min	30min	45min	1h	3h	5h	10h	20h
1.60V/cell	230.3	158.1	114.1	68.9	50.4	36.6	16.6	11.2	6.71	3.49
1.65V/cell	221.0	143.2	111.6	67.7	49.9	36.2	16.5	11.2	6.66	3.41
1.70V/cell	200.6	138.2	110.0	67.2	49.3	35.9	16.4	11.1	6.58	3.38
1.75V/cell	181.1	127.3	106.9	66.7	47.7	35.8	16.3	11.1	6.50	3.33
1.80V/cell	164.7	118.2	99.2	62.7	47.2	34.0	15.4	10.6	5.69	3.09

Constant Power Discharge Characteristics Unit:W(25°C,77°F)

F.V/Time	5min	10min	15min	30min	45min	1h	3h	5h	10h	20h
1.60V/cell	380.2	261.4	205.9	130.7	98.5	65.9	32.6	20.2	12.0	6.05
1.65V/cell	364.3	259.8	204.6	126.7	97.7	65.3	32.3	20.1	11.9	6.00
1.70V/cell	340.6	253.4	200.6	124.1	95.0	65.0	32.1	20.0	11.8	5.95
1.75V/cell	316.8	237.6	187.4	117.5	94.2	64.3	32.0	19.9	11.7	5.90
1.80V/cell	285.1	221.8	176.9	116.2	91.5	61.1	29.7	18.9	10.3	5.58

All mentioned values are average values.

TEMPERATURE EFFECTS CURVE

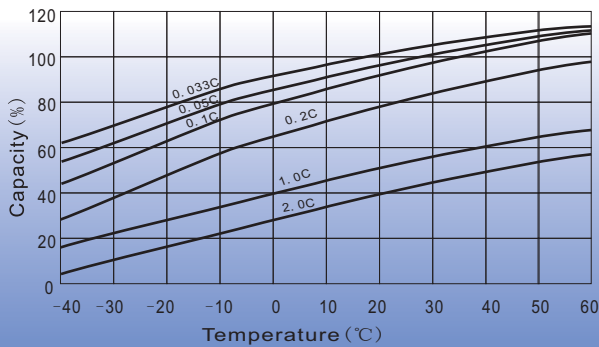

DISCHARGE TIME VS. DISCHARGE CURRENT (25°C)

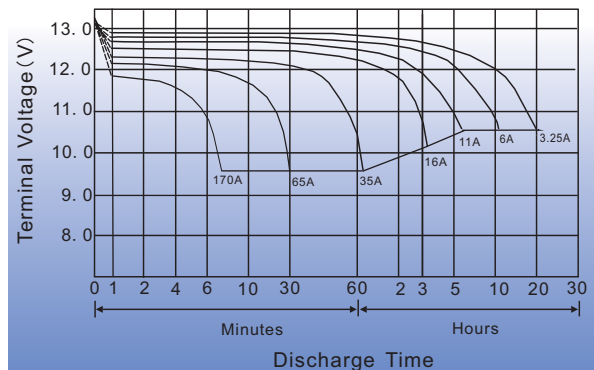

LIFE CHARACTERISTICS OF CYCLIC USE

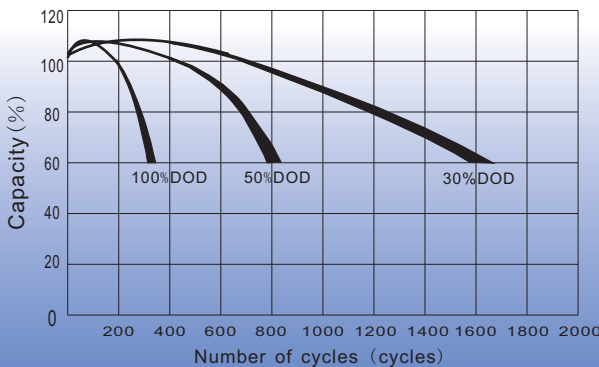

SELF-DISCHARGE CHARACTERISTIC

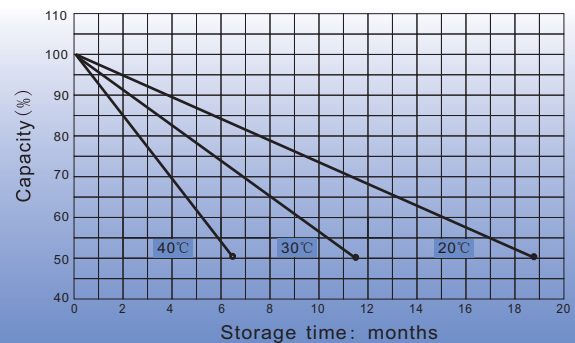

EFFECT OF TEMPERATURE ON LONG TERM FLOAT LIFE

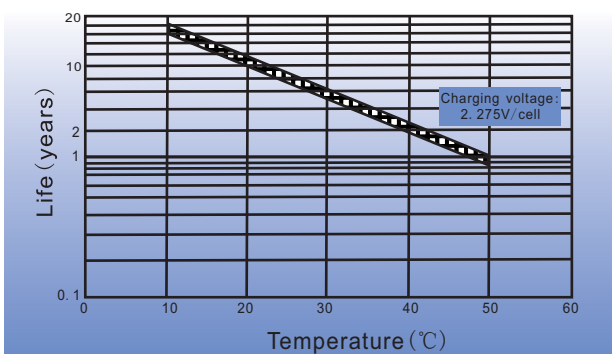

CHARGE CHARACTERISTIC CURVE FOR STANDBY USE

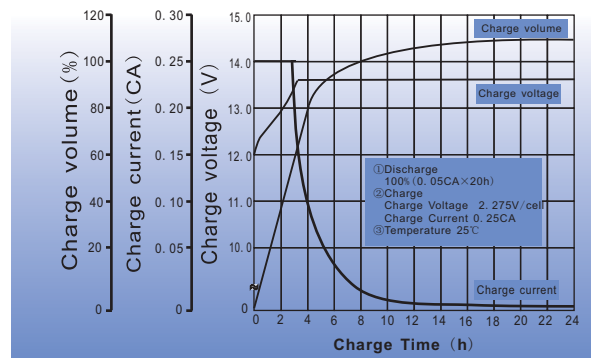

Charging Procedures

Application	Charge Voltage (V/cell)			Max. Charge Current
	Temperature	Set Point	Allow able Range	
Cycle Use	25°C	2.475	2.45~2.50	0.25C
Standby Use	25°C	2.275	2.25~2.30	

Charge the batteries at least once every 6 months, if they are stored at 25°C.

Charging Method

Constant Voltage	14.7~15.0V, 5~11h, Max. Current 0.25CA
Constant Current	0.1CA x 5h
Fast	0.25CA x 1.7h

Discharge Current VS. Discharge Voltage

Final Discharge Voltage V/cell	1.75	1.7	1.6	1.3
Discharge Current(A)	0.2C > (A)	0.2C < (A) < 0.5C	0.5C < (A) < 1.0C	(A) > 1.0C