



SPECIFICATIONS

Cells Per Unit	6
Voltage Per Unit	12
Capacity	40Ah@10hr-rate to 1.75V per cell@25°C
Weight	Approx. 12kg
Max. Discharge Current	400A (5sec)
Internal Resistance	Approx. 7.8mΩ
Operating Temperature Range	Discharge: -40°C ~ 50°C Charge: -20°C ~ 50°C Storage: -20°C ~ 50°C
Normal Operating Temperature Range	25°C ± 5°C
Float charging Voltage	13.50 to 13.80V DC/unit Average at 25°C
Max. Charging Current	10A
Equalization and Cycle service	14.70 to 15.00V DC/unit Average at 25°C
Self Discharge	The batteries can be stored for more than 6 months at 25°C. Please charge batteries before using. For high temperature, the time interval will be shorter.
Terminal	T4 / T12
Constainer Material	ABS(UL94-HB) Flammability resistance of UL94-V0 is available on request.

APPLICATION

- Electric tools
- Vehicle in place of walking
- Lawn mowers
- Golf trolleys and golf cart
- Portable apparatus, lights and instruments;
- Electric toys
- Illumination light
- Fire alarms
- Portable power
- Wheelchairs
- Medical equipments.



ISO9001

DIMENSIONS

Unit: mm

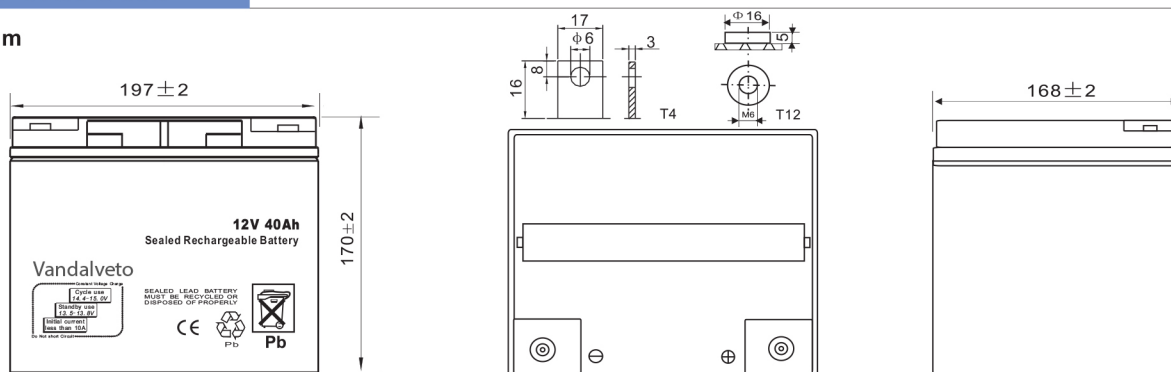

Constant Current Discharge Characteristics Unit:A(25°C,77°F)

F.V/Time	5min	10min	15min	30min	45min	1h	3h	5h	10h	20h
1.60V/cell	153.6	105.4	76.1	46.0	33.6	22.5	11.2	6.90	4.13	2.15
1.65V/cell	147.3	95.5	74.4	45.1	33.3	22.3	11.1	6.90	4.10	2.10
1.70V/cell	133.7	92.2	73.4	44.8	32.9	22.1	11.0	6.80	4.05	2.08
1.75V/cell	120.8	84.8	71.3	44.4	31.8	22.0	11.0	6.80	4.00	2.05
1.80V/cell	109.8	78.8	66.1	41.8	31.5	20.9	10.2	6.50	3.50	1.90

Constant Power Discharge Characteristics Unit:W(25°C,77°F)

F.V/Time	5min	10min	15min	30min	45min	1h	3h	5h	10h	20h
1.60V/cell	253.4	174.2	137.3	87.1	65.7	44.0	21.8	13.5	8.00	4.20
1.65V/cell	242.9	173.2	136.4	84.5	65.1	43.5	21.5	13.4	7.90	3.98
1.70V/cell	227.0	169.0	133.8	82.7	63.4	43.3	21.4	13.3	7.83	3.96
1.75V/cell	211.2	158.4	125.0	78.3	62.8	42.9	21.3	13.3	7.78	3.95
1.80V/cell	190.1	147.8	117.9	77.4	61.0	40.8	19.8	12.6	6.86	3.72

All mentioned values are average values.

TEMPERATURE EFFECTS CURVE

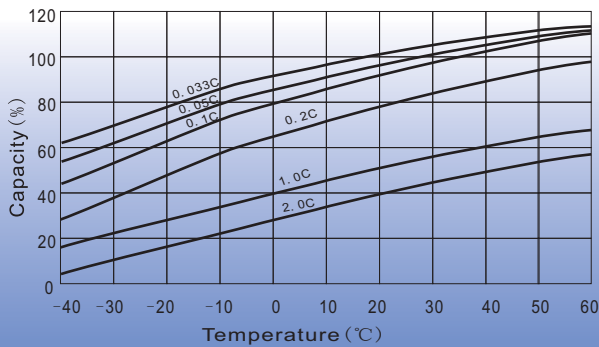

DISCHARGE TIME VS. DISCHARGE CURRENT (25°C)

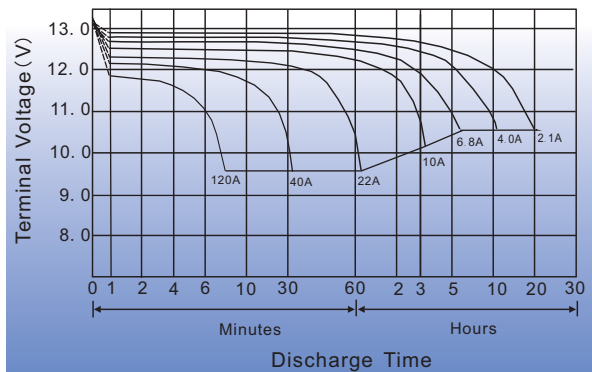

LIFE CHARACTERISTICS OF CYCLIC USE

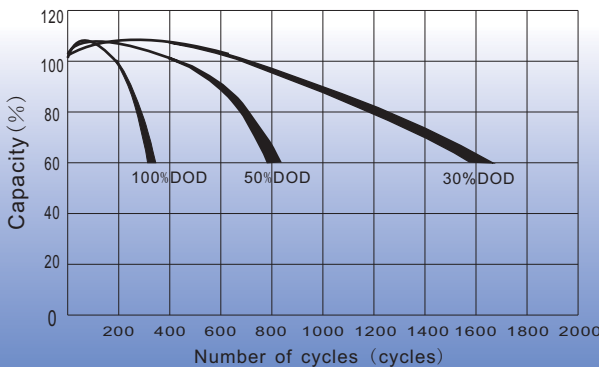

SELF-DISCHARGE CHARACTERISTIC

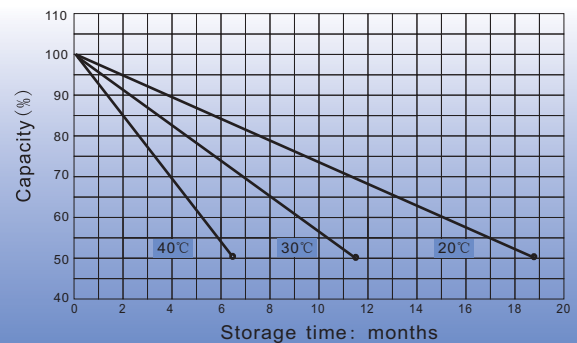

EFFECT OF TEMPERATURE ON LONG TERM FLOAT LIFE

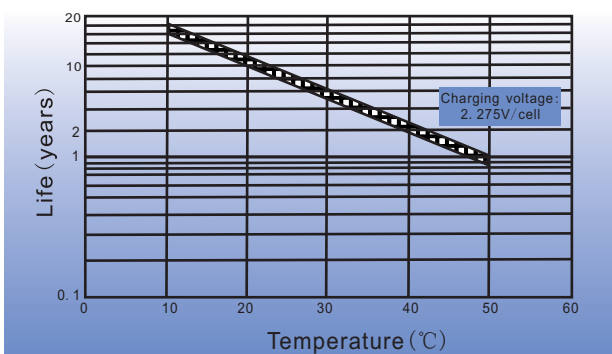

CHARGE CHARACTERISTIC CURVE FOR STANDBY USE

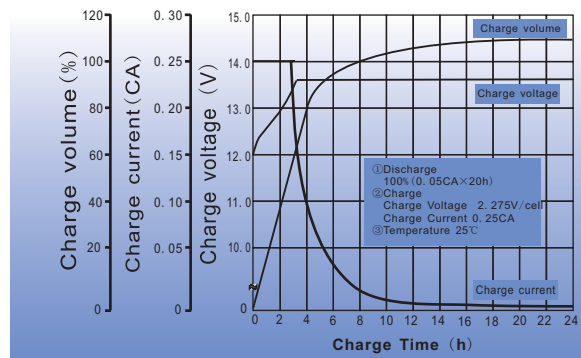

Charging Procedures

Application	Charge Voltage (V/cell)			Max. Charge Current
	Temperature	Set Point	Allow able Range	
Cycle Use	25°C	2.475	2.45~2.50	0.25C
Standby Use	25°C	2.275	2.25~2.30	

Charge the batteries at least once every 6 months, if they are stored at 25°C.

Charging Method

Constant Voltage	14.7~15.0V, 5~11h, Max. Current 0.25CA
Constant Current	0.1CA×5h
Fast	0.25CA×1.7h

Discharge Current VS. Discharge Voltage

Final Discharge Voltage V/cell	1.75	1.7	1.6	1.3
Discharge Current(A)	0.2C > (A)	0.2C < (A) < 0.5C	0.5C < (A) < 1.0C	(A) > 1.0C